



Northumberland Way, Sharston

£250,000

🛏️ 2 🚿 1 🚗 1

- Stunning 2 bed mid mews
- Brand new fitted kitchen
- off road parking
- Upvc double glazed
- Council tax -B
- Show home condition
- Brand new fitted bathroom
- Attractive landscaped rear.
- Leasehold -965 years remaining
- EPC- C



Show house condition! Recently refurbished with new kitchen, bathroom, carpets and redecoration, this is a must view property. An excellent 2 bed mid mews home forming part of a popular modern development. The double glazed accommodation features, entrance hall, lounge, brand new fitted kitchen with built in appliances including dishwasher, 2 bedrooms, the master with built in wardrobe and new contemporary bathroom. Outside there is a hardstanding for parking and to the rear there is an attractive landscaped garden. An opportunity not to be missed!





GROUND FLOOR
277 sq.ft. (25.7 sq.m.) approx.

1ST FLOOR
277 sq.ft. (25.7 sq.m.) approx.

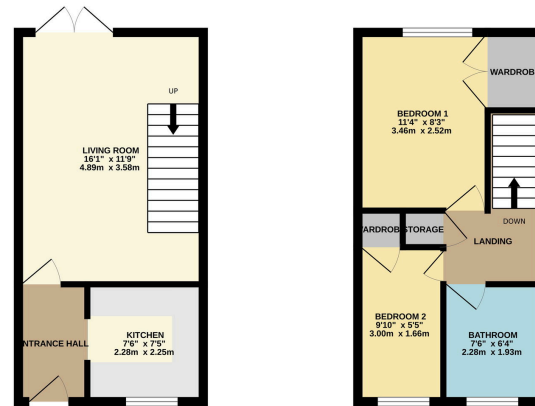

TOTAL FLOOR AREA: 553 sq.ft. (51.4 sq.m.) approx.
UK Energy Rating has been made to comply with the requirements of the European Commission's Regulations of energy, carbon, and any other factors are agreed and the responsibility is taken for any work. Approval is not required. This plan is for illustrative purposes only and should not be used for any prospective purchase. The services, systems and materials shown here have been tested and not guaranteed. Made with Bluebeam 12/22



Energy Efficiency Rating		
	Current	Potential
Very energy efficient – lower running costs		
(92 plus) A		
(81-91) B		85
(69-80) C	77	
(55-68) D		
(39-54) E		
(21-38) F		
(1-20) G		
Not energy efficient – higher running costs		
England & Wales	EU Directive 2002/91/EC	

9 Gatley Road, Cheshire SK8 1LY Tel. 0161 428 1488 Fax. 0161 428 1479
 Email. mail@andrewdawson.co.uk